

**PRODUCT NAME**

**Double Abdominal bench**

**PRODUCT CODE**

**WB03**

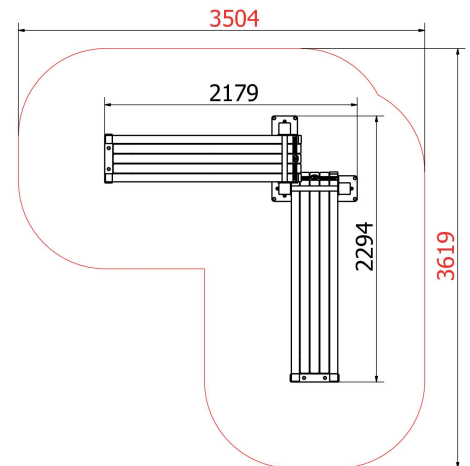
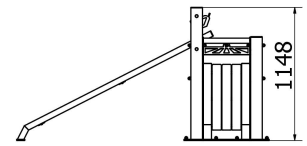

## DESCRIPTION

Our double inclined bench made of hi-quality wood and strength steel offers a lot of opportunities for exercise of abdominal muscles. Its two integrated benches with different angles of inclination will let you choose the right amount of exercise. It is a perfect complement to any of our street workout parks.

## SEGMENTS

### Basic information

**Brand** RVL13  
**Usage** exercise, stretching, strengthening

### Technical Specification

**Dimensions** 2179cm x 2295cm x 1150cm  
**Critical fall height (HIC in m)** 1.00m  
**Color scale** RAL Palette  
**Stand count** 2+  
**Surface**  
A) sprayed zinc base + komaxit 120µ B) hot dip galvanization + komaxit 120µ

Materials	Diameter	Width
<b>Dips</b>	51mm	4,5mm
<b>Bars</b>	33,7mm	3,5 - 4,5mm
<b>Pillar (square plan)</b>	100mm	4,0mm

### Recommended flooring

**Optimal dimensions** 5m x 5m  
**Floor surface** Concrete slab + EPDM or concrete feet + loose material

Company Enuma Elis s.r.o. always recommends installation in accord with the safety norm 16:630

### Delivery and installation

**Lead time** 5 - 8 weeks  
**Standards** EN16:630